

CITY OF NAPOLEON WATER TAPPING PERMIT FORM

PERMIT #:

ISSUED:

JOB LOCATION: _____

SUBDIVISION NAME: _____ LOT #: _____

OWNER:

ADDRESS: 1071 N. Perry

CONTRACTOR: _____ PHONE: _____

TAP SIZE: 1" X 1.5" _____ 2" _____ OTHER _____

AMOUNT PAID: _____ YOKE SIZE: _____

PLUMBING CONTRACTOR: _____ PH: _____

=====

DATE OF TAP: 6-21-12 OLD TAP #: _____ NEW TAP #: _____

SIZE AND KIND OF MAIN: 4" CIP 1" copper - 90° elbow into repair clamp with Corp 18" deep

LOCATION OF MAIN: West side of N. Perry DEPTH OF MAIN: 24"

DIST FROM HYDRANT VALVE: 283' # 164 DIST TO CURB STOP FROM CORP: 12'

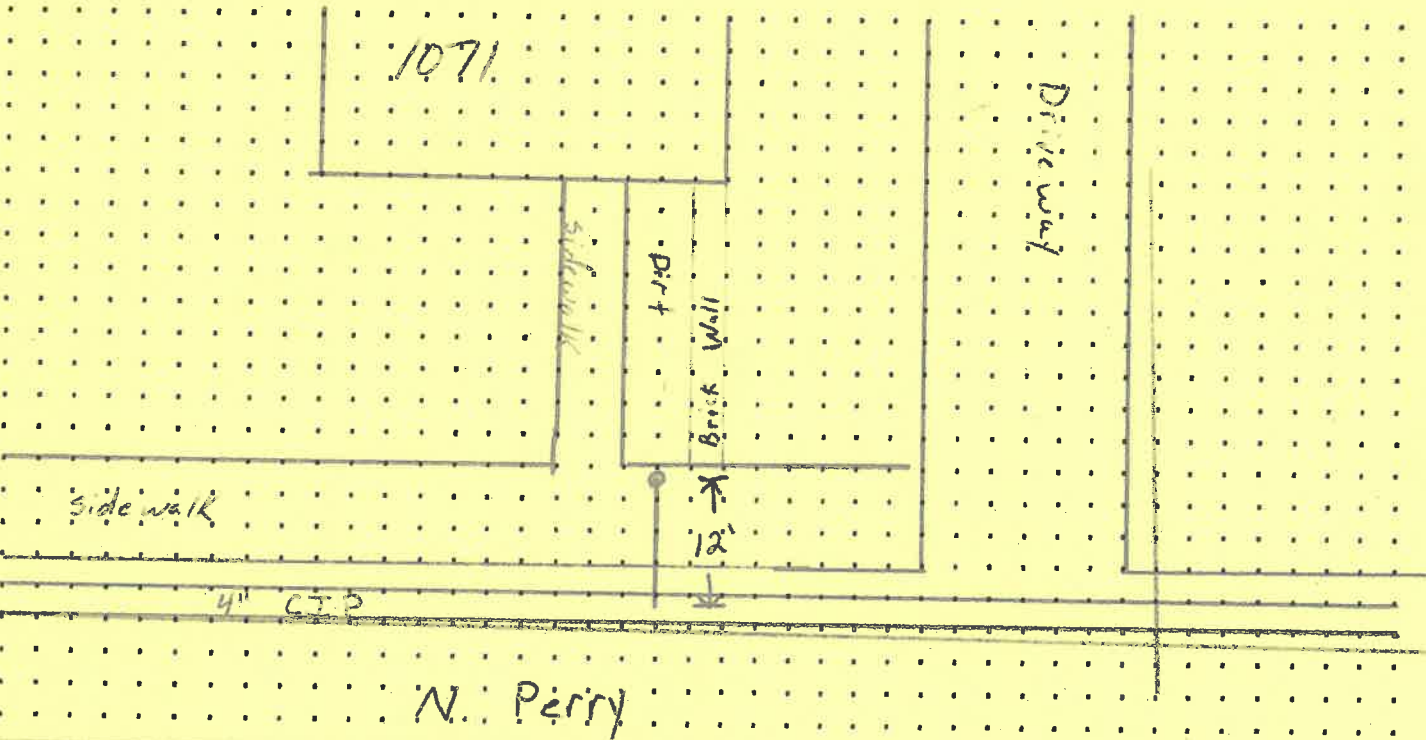

DATE APPROVED: 6-26-2012

BY: Jerry H. Parley